



Trailer Vision Catalogue 2021

Web Version

(Please see the website for retail prices, or Contact Us for trade prices)





Welcome

A little bit about our systems

Trailer Vision is an independent UK based (Limited) company that supplies the Aggregate, Commercial, Equestrian, Leisure and Plant industries with unique and innovative safety systems.

The company's founder is a qualified electronics and quality assurance engineer with a wealth of practical experience.

Both he and the company at large take pride in delivering the highest levels of customer service.

Our unique cutting-edge systems have been developed with a small selection of the world's leading manufacturers, always with a focus on functionality, practicality, durability and ease of installation in mind.

Systems are supplied with a large selection of options that can be tailored to the operator's particular requirements, whether they are a national fleet or an owner-driver.

We supply systems to meet all types of compliance (FORS/SKANSKA etc) and our standard DVS system **Cycle-Safe™** includes the latest optical detection in order to ensure vulnerable road users are always seen. See Page 10 for more information.

Our 360° Surround View (SV) systems, including DVR, are now available as **Digital HD** (720p) - a UK first. Many of our wired camera-monitor systems are now also available in Digital HD formats.

Furthermore, when a wired system is not practical we can supply 'Auto Pairing' digital wireless (DW) modules, or a 'HD' DW camera-monitor system, **Digi-Max3™**.

Whatever your particular requirement or application we are confident that we will be able to provide a practical and cost-effective solution. Please contact us today.

Need to Get in Touch?

You can reach us easily using the details below:

Trailer Vision Ltd
The Paddocks
Folksworth Road
Norman Cross
Peterborough
PE7 3SP

01733 246473
sales@trailervision.co.uk

VAT No. GB987654321
Company No. 07427963

Contents



04 Surround View Systems

The ultimate systems that provide full 360° vision, eliminating all blind spots. A must-have for when pursuing site compliance (SKANSKA, CLOCS, Crossrail etc.).



08 Recorders

Dashcams to combat the rise of 'cash for crash' schemes and 2/4/8 channel DVRs to ensure all evidence is captured in the event of an incident or accident.



10 DVS and FORS Compliance

Our guide for gaining compliance with us. See our compliant systems.



14 **Digital HD** Wired Camera Systems

Superior resolution and the highest specifications. Designed for the toughest environments.



16 **Digital HD** Wired Cameras

Compatible with our Digital HD wired camera systems and monitors.



17 **Digital HD** Wired Monitors

Available in a range of sizes and every bit as important as choosing the correct camera.



18 **Digital HD** Wired Accessories

Monitor and camera mounts, adapters, looms turning warning alarms, safety vinyl, splitters and cables.



20 Wired Camera Systems

Wired systems available with front, side, rear and interior camera. Designed for the toughest environments.



24 Wired Cameras

Compatible with our wired camera systems and monitors.



28 Wired Monitors

Available in a range of sizes and every bit as important as choosing the correct camera.



30 Wired Accessories

Monitor and camera mounts, adapters, looms, turning warning alarms, safety vinyl, splitters and cables.



34 Digital Wireless Systems

Quick to install and able to be moved between applications, vehicles and machines whenever the need arises.



38 Digital Wireless Cameras

Additional wireless cameras for use with our digital wireless systems. All are interference-free and boast a range of up to 200m.



39 Digital Wireless Monitors

Available in a range of sizes and every bit as important as choosing the correct camera.



40 Digital Wireless Accessories

Magnetic camera mounts, monitor mounts, adapters and aerials.



44 Fitting and FAQs

Installation information.

360° Surround View Systems

The ultimate safety systems for vehicles and machines

The ultimate 360° camera systems that eliminate all blind spots, providing drivers with superior situational awareness. At Trailer Vision, we have the UK's largest range of surround view (SV) systems for all applications, including the brand-new **Digital HD** series and a low cost 12V option for LCVs.

SV systems utilise four ultra-wide angle cameras that are connected to an Electronic Control Unit (ECU). The ECU 'stitches' the images together to provide the driver with a complete 360° view around the vehicle in a single image.

Calibration

In order to be at their best, our SV systems must be calibrated to the machine or vehicle that they are installed onto.

This is generally done at the time of install by our engineers using a calibration kit.

The process can also be completed by us remotely (via email) or at our premises.

Individual camera images are also displayed automatically at the relevant time (i.e., the rear camera view appears when reversing and the nearside camera view appears when indicating left).

Both the 'look-down'/360° view and the individual camera views are tailored to the vehicle/machine. Additionally, default views and system functionality can be tailored to meet customer - or compliance - requirements.

When utilised in conjunction with a DVR, SV systems ensure all evidence of any potential incidents or accidents is captured.

Default Views

All views can be tailored to operator requirements



Default View



Reversing View

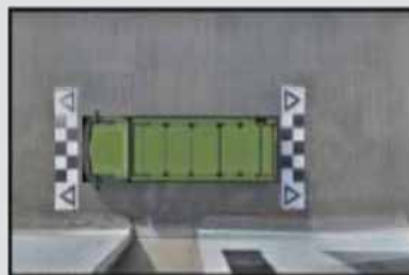

Top View (Via Hazards)



Left View



Right View



Alternative Default View



Digital HD Surround View Systems

New!

A3328



Omni-Vue™ 360° **Digital HD**

12V/24V

Utilising next-generation **Digital HD** technology, Omni-Vue™ 360° Digital HD provides a high-quality image in all light conditions.

This system was designed for commercial fleets, coaches and motorhomes. Additionally, the system can be utilised with two vertically mounted monitors for the ultimate vision solution.

- » A3328 - With a 7 Inch **Digital HD** Monitor (M3385)
- » A3501 - With 2x 7 Inch **Digital HD** Monitors (M3385)
- » A3421 - With a 7 Inch **Digital HD** Monitor (M3437)

A3371



Omni-Plant™ 360° **Digital HD**

12V/24V

Utilising next-generation **Digital HD** technology, Omni-Plant™ 360° Digital HD provides a high-quality image in all light conditions.

This system was designed for plant and machinery of all sizes and types.

The 50:50 display is specifically suited to machine applications and where compliance (SKANKA etc) requires a 5m view of all sides of the machine (look-down view).

- » A3371 - With a 7 Inch **Digital HD** Monitor (M3385)
- » A3457 - With a 7 Inch GP Waterproof Monitor (GP3316)



Why Omni-Vue™/Plant™ 360° **Digital HD**?

Omni-Vue™360° **Digital HD** and Omni-Plant™ 360° **Digital HD** are the first digital high-definition systems of their kind in the UK.

Digital HD cameras (720p/WDR) provide superior resolution in all light conditions, ensuring that drivers have an unsurpassed view and all blind spots are eliminated.

A **Digital HD** DVR is also now available, making our DHD systems the ultimate option in their class.



Parking Made Easier and Safer



Manoeuvre Confidently and Safely



Elimination of Blind Spots

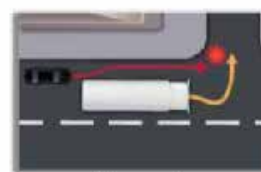

A Range of Views

Omni-Vue™ **Digital HD** Utilising Two Portrait Monitors:



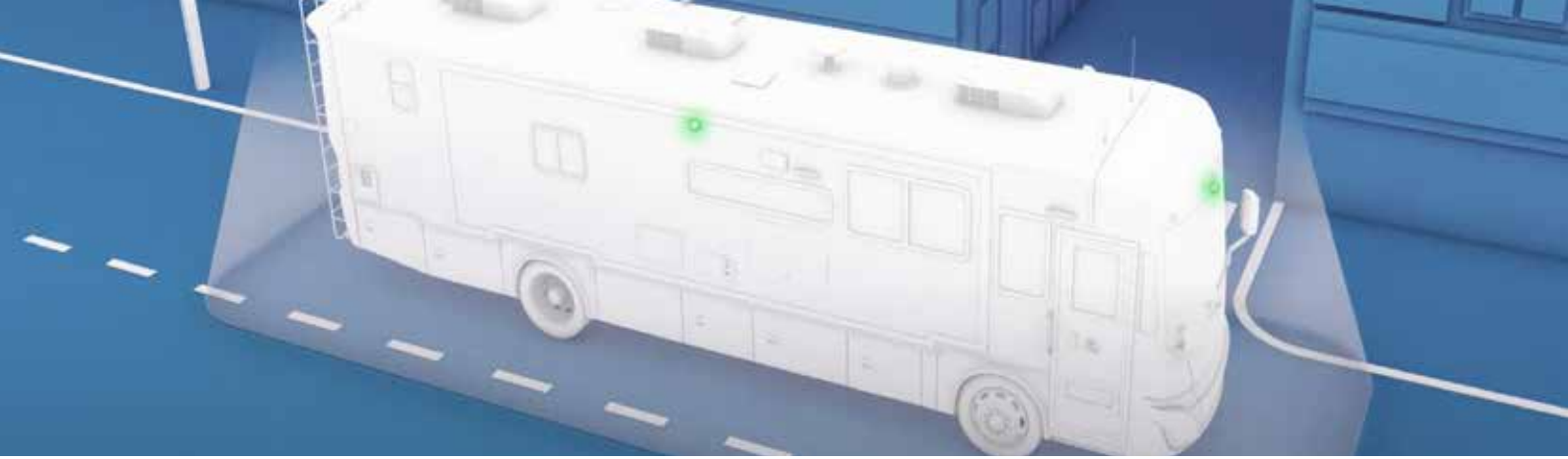

Analogue Surround View Systems

A3013



Omni-Van™ 360° 12V ONLY

Utilising four CS-5518 (C3047) cameras, Omni-Van™ was developed with LCVs and motorhomes in mind and can be tailored to customer-specific requirements.

- » A3013 - With a 7 Inch Mirror-Mounted Monitor (GP3226)
- » A3314 - With a 7 Inch GP Monitor (GP3292)
- » A3296 - With a 7 Inch 'OEM' CM-709M Monitor (M3036)5

A3412



Omni-Vue™ 360° 12V/24V

Developed for all vehicle applications, Omni-Vue™ 360° is one of our lower-cost options and utilises 540K pixel cameras alongside the latest generation analogue ECU.

- » A3412 - With a 7 Inch GP Monitor (GP3292)
- » A3507 - With a 7 Inch 'OEM' CM-709M Monitor (M3036)

**New
Lower
Price!**

A3430



Omni-Plant™ 360° 12V/24V

Developed for all machine applications, Omni-Plant™ 360° is one of our lower-cost options and utilises 540K pixel cameras alongside the latest generation analogue ECU (SKANSKA etc. compliant).

The 50:50 display is specifically suited to machine applications and wherever compliance (SKANSKA etc.) requires a 5m view of all sides of the machine (look-down view).

- » A3430 - With a 7 Inch GP Monitor (GP3292)
- » A3431 - With a 7 Inch GP Waterproof Monitor (GP3316)



**New
Lower
Price!**

DVRs and Accident Recorders

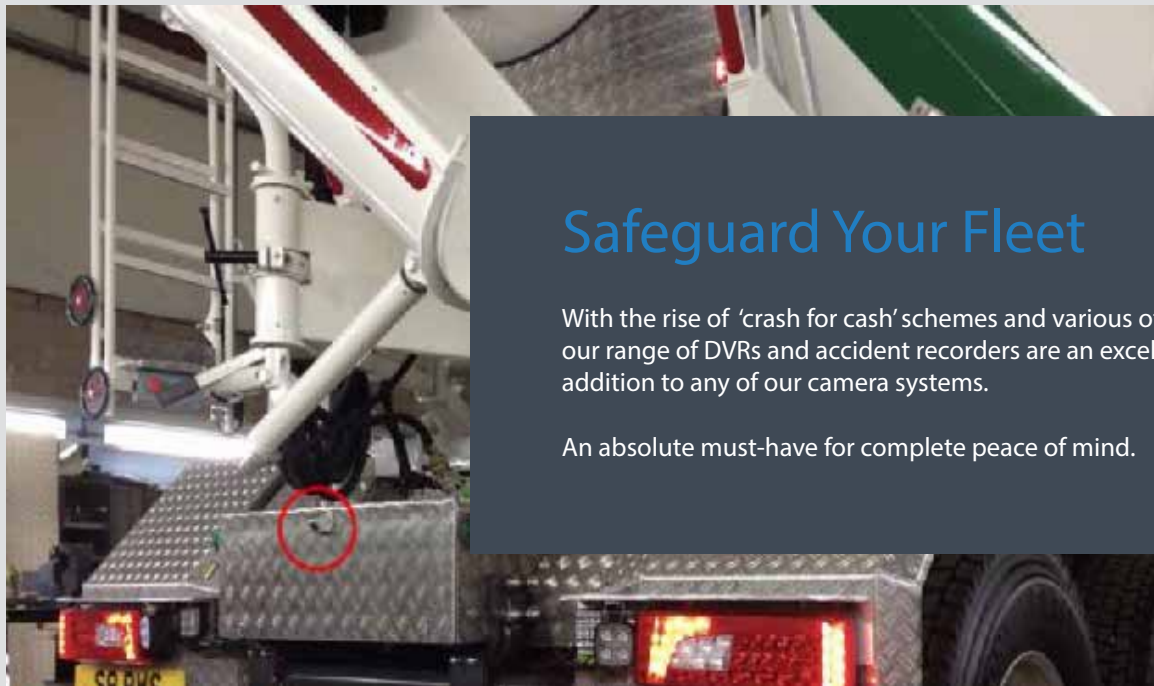

Safeguard Your Fleet

With the rise of 'crash for cash' schemes and various other scams, our range of DVRs and accident recorders are an excellent addition to any of our camera systems.

An absolute must-have for complete peace of mind.

D3451



Waterproof

Connectivity Packs

Allows remote viewing. Compatible with our Digital DVRs.

- » P3508 - Wi-Fi Connectivity Pack
- » P3509 - 3G/4G Connectivity Pack

2-Channel **Digital HD** DVR 12V/24V

Brand new to Trailer Vision, our new digital DVRs capture stunning, high-definition footage.

With the ability to connect remotely for viewing (see below for connectivity pack options), this DVR is crucial for combatting 'crash for cash' schemes while safeguarding drivers and fleet operators alike.

With two recording channels, this DVR is a great addition to any of our **Digital HD** systems.

- » D3451 - 32GB SD Storage
- » D3487 - 128GB SD Storage
- » D3488 - 256GB SD Storage
- » D3489 - 512GB SD Storage

New!

D3452



Waterproof

4-Channel **Digital HD** DVR 12V/24V

Brand new to Trailer Vision, our new digital DVRs capture stunning, high-definition footage.

With the ability to connect remotely for viewing (see below for connectivity pack options), this DVR is crucial for combatting 'crash for cash' schemes while safeguarding drivers and fleet operators alike.

With four recording channels, this DVR is a great addition to our **Digital HD** surround view systems.

- » D3452 - 32GB SD Storage
- » D3457 - 128GB SD Storage
- » D3468 - 256GB SD Storage
- » D3469 - 512GB SD Storage

New!

R3035



DR-220 Accident Recorder

12V/24V

A high quality, HDR/WDR commercial spec forward-facing accident recorder.

The unit includes the following features:

- » Built-in GPS
- » Additional camera input
- » AV out
- » 3-axis shock sensor

- » R3035 - 16GB SD Storage
- » R3261 - 64GB SD Storage
- » R3427 - 128GB SD Storage

D3027



DR-120 2-Channel DVR

12V/24V

The DR-120 utilises SD card memory for easy movement of data.

The unit includes the following features:

- » Built-in GPS
- » 2 camera inputs
- » AV out
- » 3-axis shock sensor

- » D3027 - 16GB SD Storage
- » D3438 - 64GB SD Storage
- » D3439 - 128GB SD Storage

D3021



DR-400N 4-Channel HD DVR

12V/24V

While a great addition to any of our applicable systems, the DR-400N shines when used in conjunction with surround view.

The unit includes the following features:

- » Secured hard drive
- » Built-in GPS
- » 4 camera inputs
- » AV out
- » 3-axis shock sensor

- » D3021 - 128GB SSD Storage
- » D3022 - 256GB SSD Storage
- » D3023 - 500GB SSD Storage
- » D3024 - 1TB SSD Storage
- » D3025 - 500GB HDD Storage
- » D3026 - 1TB HDD Storage

Compliance

Direct Vision Standard



What is the Direct Vision Standard?

Initially launched in October 2019, the newly introduced Direct Vision Standard aims to promote the safety of vulnerable road users (VRUs) and HGV drivers when operating in the Greater London area. All vehicles above 12 tonnes will be affected, requiring a **Safety Permit** to be obtained.

There are two levels of compliance for DVS: 'Mandatory' and 'Recommended', both of which allow for the operation of HGVs in London.

Is there a penalty for non-compliance?

Yes. There is a steep penalty should drivers enter London without gaining compliance. Fines of £550 per vehicle, per day are currently in place for operators who are late in adopting the new standard before 31st October 2020.

What options are there?

Trailer Vision offer two main systems for DVS compliance.

The first is our brand-new optical detection system, **Cycle-Safe™** and the second is an ultrasonic/'side-scan' detection system.

The main difference between the two systems, apart from the method of detection, is that **Cycle-Safe™** can differentiate between roadside furniture (bollards, road signs etc.) and moving objects, whereas ultrasonic systems do not and are more likely to raise a false alarm.

Cycle-Safe™ incorporates the latest 'smart' optical technology to enable it to distinguish between street furniture and VRUs (cyclists, pedestrians etc.). This means that **Cycle-Safe™** has a substantially lower false alarm rate when compared with ultrasonic systems, reducing driver workload and false alarm fatigue.

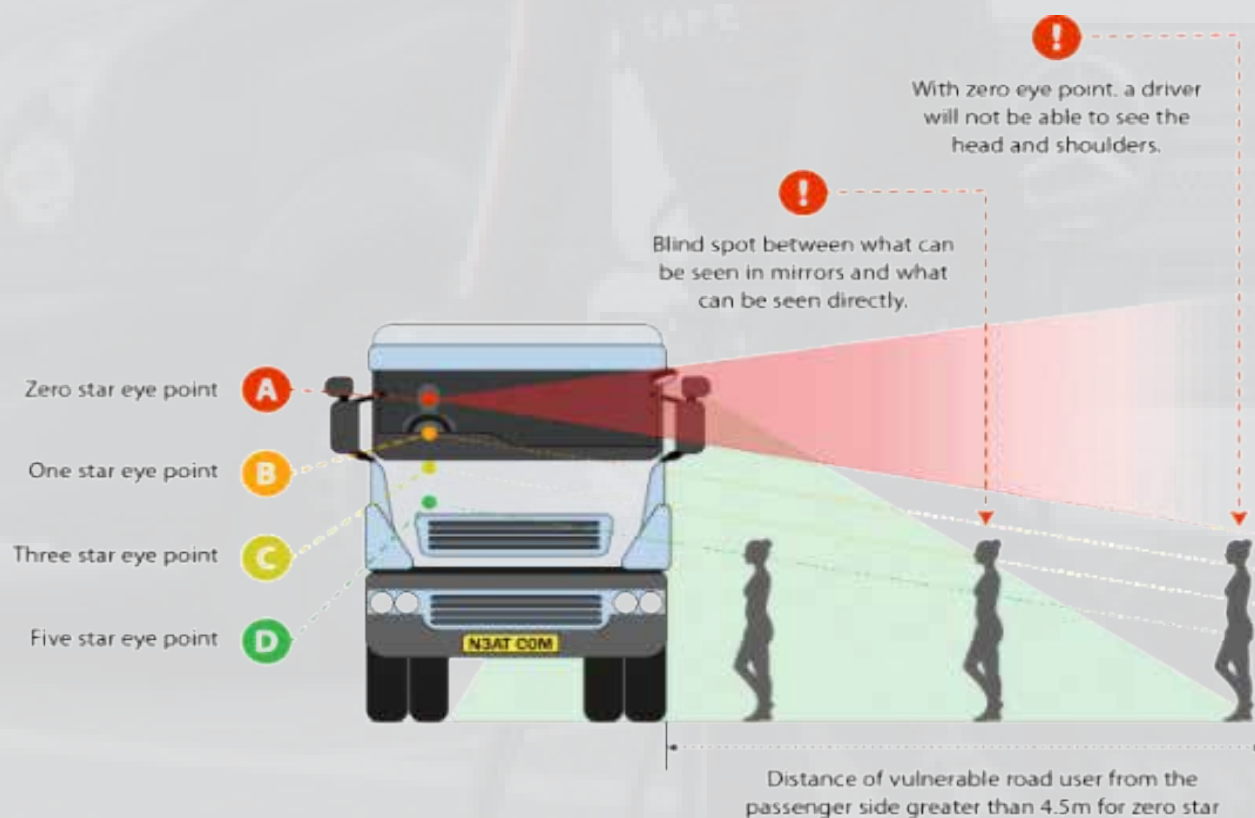

DVS Systems

What is included with each compliant system?

Option One

Cycle-Safe™ Optical Detection

Future-proof your fleet

(Please see page 23 for more information on Cycle-Safe™)



| | DVS 'Basic' System | DVS 'Recommended' System | Trailer Vision Recommended System |
|----------------------------------|-----------------------|-----------------------------|---|
| System Ref | A3386/P3392 | A3386/P3393 | A3386/P3396 |
| Cycle-Safe™ 'Smart Camera' | Y | Y | Y |
| 7 Inch Monitor | Y | Y | Y |
| Turning Warning Alarm | Y | Y | Y |
| 'Blind Spot, Take Care' Vinyl | Y | Y | Y |
| Reversing Alarm | | | Y |
| Rear Camera | | | Y |
| DVR (4 Channels) | | | Y |
| Right/Offside Camera | | | Y |
| Front Cycle-Safe™ 'Smart' Camera | | | Y |
| Front Camera (Not 'Smart') | | Y | |
| Price | £795 | £950 | £2070 |

Option Two

Ultrasonic Sensor Kit

A lower-cost alternative to Cycle-Safe™



| | DVS 'Basic' System | DVS 'Recommended' System |
|---------------------------------|-----------------------|-----------------------------|
| System Ref | A3380/A3413 | A3380/A3414 |
| Left/Nearside Camera | Y | Y |
| Ultrasonic Sensor System (Left) | Y | Y |
| 7 Inch Monitor | Y | Y |
| Turning Warning Alarm | Y | Y |
| 'Blind Spot, Take Care' Vinyl | Y | Y |
| Front Camera (Not 'Smart') | | Y |
| Price | £445 | £595 |

A Note Regarding
Ultrasonic Systems:

**Cycle-Safe™ is
recommended for
DVS compliance.**

Ultrasonic systems may
become non-compliant
after 2024, following
the TfL Safe Systems
Review in 2022.

FORS

What is the Fleet Operator Recognition Scheme?

The Fleet Operator Recognition Scheme (FORS) is a voluntary accreditation for fleet operators that aims to raise the level of safety within fleet operations and demonstrate publicly which operators are achieving best practice in safety, efficiency and environmental protection.

Like DVS, there are two levels of compliance: 'Basic' and 'Recommended'.

What are the benefits?

There are numerous benefits to being with FORS, including:

- Advice, guidance and campaign toolkits
- Discounts from FORS associate suppliers
- Access to performance management tools
- Access to eLearning modules
- Regular news and bulletins
- Training for HGV drivers
- Training for van drivers
- Best practice courses and workshops for managers



Is there a penalty for non-compliance?

While there are no legal penalties for choosing not to comply with the scheme, there can be negative consequences. One example is that some potential customers may only wish to work with fleets that adhere to FORS guidelines and can prove compliance.

What options are there?

Like the DVS options on the previous page, Trailer Vision can offer two main options for gaining FORS compliance.

The first is our brand-new optical detection system, Cycle-Safe™ and the second is an ultrasonic/'side-scan' detection system.

The main difference between the two systems, apart from the method of detection, is that Cycle-Safe™ can differentiate between roadside furniture (bollards, road signs etc.) and moving objects, whereas ultrasonic systems do not and are more likely to raise a false alarm.

Cycle-Safe™ incorporates the latest 'smart' optical technology to enable it to distinguish between street furniture and VRUs (cyclists, pedestrians etc.). This means that Cycle-Safe™ has a substantially lower false alarm rate when compared with ultrasonic systems, reducing driver workload and false alarm fatigue.

For more information on Cycle-Safe™, please refer to page 16.

FORS Systems

What is included with each compliant system?

Option One

Cycle-Safe™ Optical Detection

Future-proof your fleet

(Please see page 23 for more information on Cycle-Safe™)



| | FORS 'Basic' System | FORS 'Recommended' System | Trailer Vision Recommended System |
|----------------------------------|------------------------|------------------------------|---|
| System Ref | A3386/P3394 | A3386/P3395 | A3386/P3396 |
| Cycle-Safe™ 'Smart Camera' | Y | Y | Y |
| 7 Inch Monitor | Y | Y | Y |
| Turning Warning Alarm | Y | Y | Y |
| 'Blind Spot, Take Care' Vinyl | Y | Y | Y |
| Reversing Alarm | Y | Y | Y |
| Rear Camera | Y | Y | Y |
| DVR (4 Channels) | | Y | Y |
| Right/Offside Camera | | Y | Y |
| Front Cycle-Safe™ 'Smart' Camera | | | Y |
| Front Ultrasonic Sensors | | Y | |
| | | | |

Option Two

Ultrasonic Sensor Kit

A lower-cost alternative to Cycle-Safe™



| | FORS 'Basic' System | FORS 'Recommended' System |
|---------------------------------|------------------------|------------------------------|
| System Ref | A3380/A3415 | A3380/A3416 |
| Left/Nearside Camera | Y | Y |
| Ultrasonic Sensor System (Left) | Y | Y |
| 7 Inch Monitor | Y | Y |
| Turning Warning Alarm | Y | Y |
| 'Blind Spot, Take Care' Vinyl | Y | Y |
| Reversing Alarm | Y | Y |
| Rear Camera | Y | Y |
| DVR (4 Channels) | | Y |
| Right/Offside Camera | | Y |
| Front Ultrasonic Sensors | | Y |
| | | |

OEM Spec *Digital HD* Wired Camera Systems

The latest *Digital HD* (TVI) camera systems. Supplied with either a 7 inch or 10 inch *Digital HD* monitor. A variety of camera cases and lens angles are available. Suitable for all applications where superior resolution is required.

A3490/91

New!



Digital HD Camera Systems (7 Inch Monitor)

The highest specification in wired camera systems. Front, side, reverse and load cameras are available.

- » 2.1MP/WDR lens (1280 x 720)
- » Durable and reliable (IP69K)
- » Heated lens (option)
- » Camera microphone (option)
- » IR (option)
- » 3 year warranty

- » A3490 - Kit with 1 camera
- » A3491 - Kit with 2 cameras

A3492/93

New!



Digital HD Camera Systems (10 Inch Monitor)

The highest specification in wired camera systems. Front, side, reverse and load cameras are available.

- » 2.1MP/WDR lens (1280 x 720)
- » Durable and reliable (IP69K)
- » Heated lens (option)
- » Camera microphone (option)
- » IR (option)
- » 3 year warranty

- » A3492 - Kit with 1 camera
- » A3493 - Kit with 2 cameras

OEM specifications and next-generation **Digital HD** resolution.

A3494

New!



Multi-Vue™ **Digital HD**

Multi-Vue™ is an innovative and compact single-lens camera system that provides two views.

The first view is a 'look-down' view when reversing and the second is a 'look-back' view when travelling forwards.

- » 2.1MP/WDR lens (1280 x 720)
- » 'Look-down' view is triggered when reversing
- » 'Look-back' view is triggered when moving forward and acts like a mirror
- » Reliable and proven
- » 7 inch monitor
- » Suitable for FIAT & Peugeot Chassis/Vans
- » 3 year warranty

- » A3494 - Kit with 1 camera

A3495/6

New!



Brake Light Camera System

A **Digital HD** camera built into a brake light housing, which can be supplied with or without a brake light.

- » 2.1MP/WDR lens (1280 x 720)
- » 7 inch monitor included as standard
- » Waterproof monitor available (+£80)
- » Suitable for FIAT & Peugeot Chassis/Vans
- » 3 year warranty

- » A3495 - Without brake light
- » A3496 - With brake light

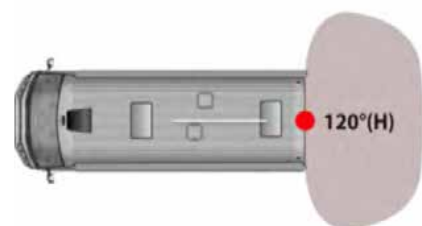
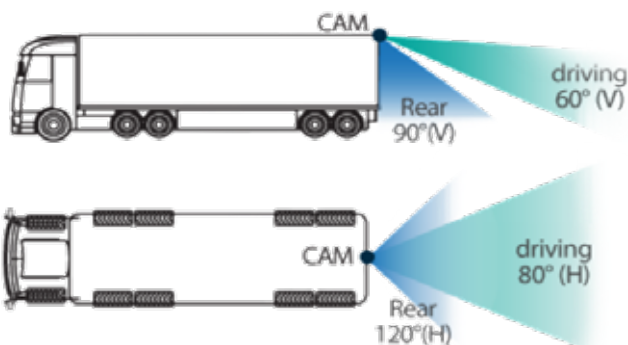

Digital HD Wired Cameras

Compatible with our digital products

C3333



Omni-Vue™/Plant™ Digital HD Camera

For use with Omni-Vue™/Plant™ Digital HD.

- » Only digital camera of its kind in the UK
- » 180° viewing angle
- » Durable and reliable (IP69K)
- » 3 year warranty

C3504



Digital Shutter Camera

A Digital HD shutter camera.

- » 120° viewing angle
- » Durable and reliable (IP69K)
- » IR (Night Vision)
- » 3 year warranty

C3505



CS-45XX

A Digital HD multi-use camera.

- » 154° viewing angle
- » Durable and reliable (IP69K)
- » IR (Night Vision)
- » 3 year warranty

C3506



Digital Heavy Duty Camera

A Digital HD heavy duty reversing camera.

- » 120° viewing angle
- » Durable and reliable (IP69K)
- » IR (Night Vision)
- » 3 year warranty

The CS-45XX is compatible with a variety of cases, as shown below:



Standard
Type

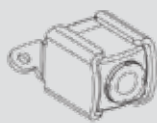

S-Type
(Small)

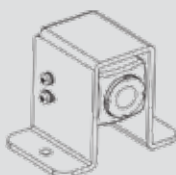

D-Type
(Dashboard)

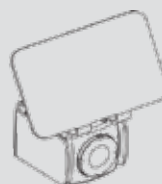

W-Type
(Windshield)

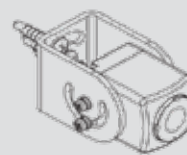

WA-Type
(Wall)

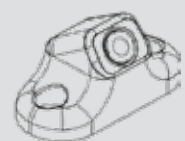

Design
Type

Digital HD Wired Monitors

Compatible with our digital cameras

M3340



CM-720/L

A **Digital HD** 7 inch high-quality plastic monitor, ideal for use with Digital HD cameras and systems.

- » One input
- » 7 inch **Digital HD** screen
- » Landscape configuration

M3437



CM-1000/L

A **Digital HD** 10 inch high-quality plastic monitor, ideal for use with Digital HD cameras and systems.

- » One input
- » 10 inch **Digital HD** screen
- » Landscape configuration

M3502



CM-720/P

A **Digital HD** 7 inch high-quality plastic monitor, ideal for use with Digital HD cameras and systems.

- » One input
- » 7 inch **Digital HD** screen
- » Portrait configuration

M3503



CM-1000/P

A **Digital HD** 10 inch high-quality plastic monitor, ideal for use with Digital HD cameras and systems.

- » One input
- » 10 inch **Digital HD** screen
- » Portrait configuration

Digital HD Wired System Extras and Accessories

P1058



Digital Wireless Modules

Enables any of our **Digital HD** and analogue wired systems to be operated wirelessly.

- » Ideal for operating multiple trailers
- » No physical tractor/trailer connection
- » Automatic pairing
- » Water-resistant, IP69K
- » Interference-free with a range of up to 100m
- » 3 year warranty

P1091



GP TX & RX

A lower-cost, non-waterproof alternative to Digital Wireless Modules (P1058). Compatible with **Digital HD** and analogue wired systems.

- » Ideal for operating multiple trailers
- » No physical tractor/trailer connection
- » Interference-free with a range of up to 100m
- » 2 year warranty

P31XX



Monitor Mounts

Allows monitors to be mounted to a dashboard, windscreen or roof.

Mounts are available for all our monitors. Please get in touch for assistance.

P30XX



Camera Mounts

Available for all cameras. Please contact us for assistance.

P3337/38/39



Digital HD Camera Extension Cable, 6 Pin

Available in the following lengths:

- » P3337 - 5m Length
- » P3338 - 10m Length
- » P3339 - 18m Length

P30XX



Monitor Power Looms

Available for all monitors. Please contact us for assistance.

P3484



Digital Splitter Cable, 6 Pin

Available in the following lengths:

- » P3484 - 45cm Length

P3315



Calibration Kit

Needed when installing a surround view system without the aid of our engineers.

The cost of the calibration kit is fully refundable upon its return to us.

Analogue Wired Camera Systems

Great value and suitable for the harshest of environments

GP3217/16/390/391



GP 1-3 Camera Kit

Our GP camera systems all come with a 7 inch monitor as standard and are able to be used with up to three cameras at a time.

We have a range of cameras to choose from, including side cameras, reversing cameras and standard forward-facing cameras.

- » Robust and durable
- » 7 inch monitor included as standard
- » Waterproof monitor available
- » Suitable for virtually any vehicle
- » Supports up to three camera connections at a time
- » Front, rear and side camera types available
- » Night vision capability (IR)
- » High resolution
- » 2 year warranty

- » GP3217 - Kit with 1 camera
- » GP3216 - Kit with 2 cameras
- » GP3390 - Kit with 3 cameras

A3408/09/10/11



OEM Spec 1-4 Camera System

The highest specification in wired camera systems. Front, side, reverse and load cameras are available.

- » Night vision capability (optional)
- » Durable and reliable (camera is rated IP69K)
- » Heated lens (optional)
- » Camera microphone (optional)
- » WDR/1.3MP camera lens
- » Waterproof monitor available
- » 3 year warranty

- » A3408 - Kit with 1 camera
- » A3409 - Kit with 2 cameras
- » A3410 - Kit with 3 cameras
- » A3411 - Kit with 4 cameras

K33XX



A3149/428



MAN-Specific Systems

Specified by MAN Truck and Bus UK as their camera systems of choice.

- » Night vision capability
- » Durable and reliable (camera is rated IP69K)
- » WDR/1.3MP camera lens
- » MMT adapter included in kits
- » 3 year warranty

Compatible with MMT1 head unit

- » K3355 - MMT1 Reversing Camera Kit
- » K3357 - MMT1 Reversing & Side Camera Kit
- » K3359 - MMT1 Dual Reversing Camera Kit

Compatible with MMT2 head unit

- » K3356 - MMT2 Reversing Camera Kit
- » K3358 - MMT2 Reversing & Side Camera Kit
- » K3360 - MMT2 Dual Reversing Camera Kit

Compatible with MMT3 head unit

- » K3461 - MMT3 Reversing Camera Kit
- » K3481 - MMT1 Reversing & Side Camera Kit
- » K3482 - MMT1 Dual Reversing Camera Kit



Multi-Vue™

Multi-Vue™ is an innovative and compact single-lens camera system that provides two views.

The first view is a 'look-down' view when reversing and the second is a 'look-back' view when travelling forwards.

- » 1.3MP/WDR camera lens
- » Choice of a stainless steel OR polycarbonate camera case
- » 'Look-down' view is triggered when reversing
- » 'Look-back' view is triggered when moving forwards and acts like a mirror
- » Reliable and proven
- » Choice of a 5 inch dash-mounted monitor OR a 7 inch mirror-mounted monitor (no pricing change)
- » 2 year warranty

- » A3149 - With a 5 Inch Dash-Mounted Monitor
- » A3428 - With a 7 Inch Mirror-Mounted Monitor

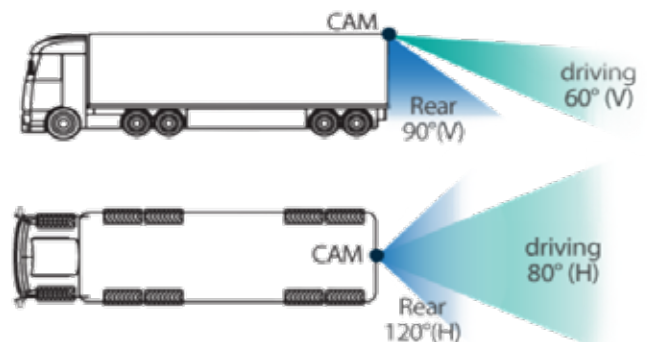

Cycle-Safe™ Optical Detection System

Fully operational whether the vehicle is moving or stationary

A1070

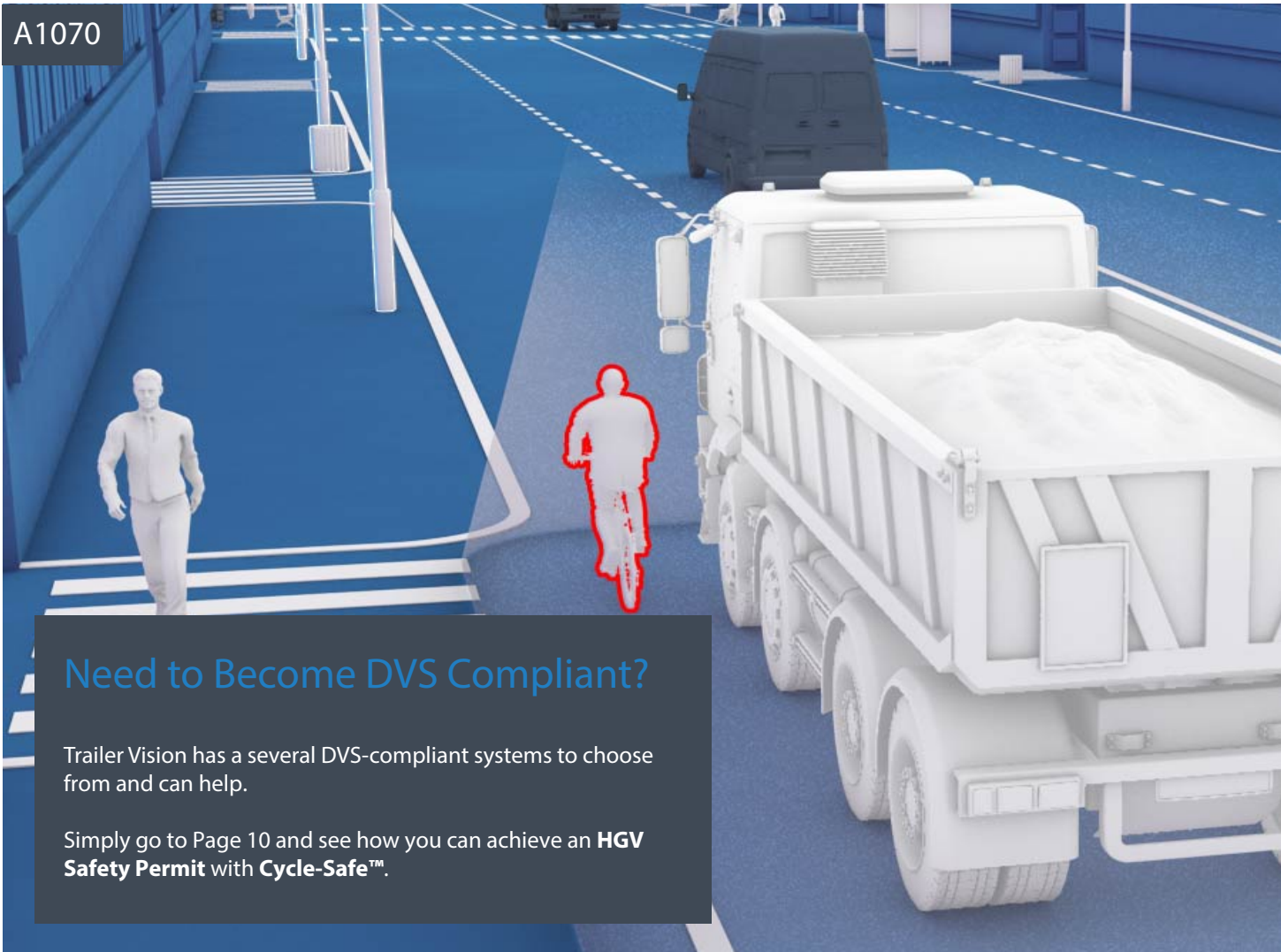

Need to Become DVS Compliant?

Trailer Vision has a several DVS-compliant systems to choose from and can help.

Simply go to Page 10 and see how you can achieve an **HGV Safety Permit** with **Cycle-Safe™**.

Cycle-Safe™

BRAND NEW!

Cycle-Safe™ utilises next generation optical technology, combining detection and vision in a single 'smart camera' that is fully operational when the vehicle is moving and stationary.

The intelligent system provides drivers with audible alerts, enabled when turning (indicating), and 'always on' visual warnings (monitor can be disabled above 20 MPH).

Unlike ultrasonic sensors/'side-scan' systems, Cycle-Safe™ differentiates between moving (VRU's) and static objects (street furniture), significantly reducing driver workload and false alarms.

A recent 'Cyclist Detection System' test conducted April 2019 in Germany (by ADAC) discovered that an ultrasonic/'side-scan' system, also supplied in the UK, had a false detection rate of 59% and could not be recommended.

- » A3380 - Cycle-Safe™ (No Monitor)
- » A3386 - Cycle-Safe™ with 7 Inch Monitor

A3386



A representation of what a typical Cycle-Safe™ installation might look like from the cab:



P3373/99



Ultrasonic Sensor Sets

Useful for obstacle detection.

- » Digital system
- » Standard & Short Range (Corner Detect)
- » 2 year warranty

- » P3373 - Ultrasonic Sensor Set
- » P3399 - Ultrasonic Sensor Set, **Corner Detect**



Analogue Wired Cameras

Compatible with our wired systems and monitors.

C3306



Industrial Reversing Camera

Specified by MAN Truck and Bus as their camera of choice.

- » Durable and reliable (IP69K)
- » 120° viewing angle
- » WDR/1.3MP and infra-red
- » Microphone and heated lens
- » 3 year warranty

C3433



Compact Reversing Camera

OEM-spec compact reversing camera.

- » Durable and reliable (IP69K)
- » 120° viewing angle
- » WDR/1.3MP and infra-red
- » Microphone and heated lens
- » 3 year warranty

GP3221



GP Reversing Camera

Fully compatible with our GP wired systems.

- » Night vision (IR)
- » 120° viewing angle
- » Durable and reliable (IP69K)
- » 2 year warranty

GP3419



GP Side Camera

Fully compatible with our GP wired systems.

- » Night vision (IR)
- » 90° viewing angle
- » Nearside and offside available
- » Durable and reliable (IP69K)
- » 2 year warranty

C3446



Side and Front Camera

OEM spec side and front camera.

- » Durable and reliable (IP69K)
- » 150° viewing angle
- » WDR/1.3MP
- » 3 year warranty

C3200P



Polycarbonate Multi-View™ Camera

Compatible with the Multi-View™ system ONLY.

- » 1.3MP/WDR
- » Driving mode 80°
- » Parking mode 120°
- » Choice of stainless steel or polycarbonate case (both IP68)
- » 'Look-down' view triggered when reversing
- » Single lens, two views
- » 3 year warranty

C3200M



Metal Multi-View™ Camera

Compatible with the Multi-View™ system ONLY.

- » 1.3MP/WDR
- » Driving mode 80°
- » Parking mode 120°
- » Choice of stainless steel or polycarbonate case (both IP68)
- » 'Look-down' view triggered when reversing
- » Single lens, two views
- » 3 year warranty
- »

C3201



Dual Lens Camera

One camera with two views.

- » Driving mode 47.5°
- » Parking mode 120°
- » Night vision (IR)
- » Durable and reliable (IP69K)
- » Microphone and heated lens
- » 3 year warranty

C3068



Interior Camera

OEM spec cab camera.

- » Compact and discreet
- » 150° viewing angle
- » Durable and reliable
- » Night vision (IR)
- » 1.3MP/WDR

C3425



Shutter Camera

High resolution shutter camera.

- » Night vision (IR)
- » 120° viewing angle
- » Durable and reliable (IP67)
- » Automatic protection cover
- » Microphone and heated lens
- » 3 year warranty

C3064



Dome Camera

Dome cameras can be used on their own or, more commonly, as part of an interior camera system.

- » 1.3MP
- » Night vision (IR)
- » 120° viewing angle
- » Durable and reliable (IP69K)
- » Heated lens
- » 3 year warranty

C3061



Omni-Vue™/Plant™ AHD Camera

For use with Omni-Vue™/Plant™ 360° Analogue HD.

- » Durable and reliable (IP69K)
- » 180° viewing angle
- » 1.3MP/WDR
- » 3 year warranty

C3047



Omni-Van™ Camera

For use with Omni-Van™ 360° or as part of a bespoke system.

- » Durable and reliable (IP69K)
- » 180° viewing angle
- » Grill-mounted version available
- » 3 year warranty

C3424



Flush-mounted Camera

OEM spec flush camera. Can be utilised with existing systems or separately.

- » Compact and discreet
- » 180° viewing angle
- » Durable and reliable (IP69K)
- » 3 year warranty

C3072



Omni-Vue™/Plant™ Camera

For use with Omni-Vue™/Omni-Plant™ or as part of a bespoke system.

- » 180° viewing angle
- » Durable and reliable (IP68)
- » 3 year warranty

Analogue Wired Monitors

Every bit as important as choosing the right camera.

M3036



CM-709 Series

OEM specification and quality.

- » Robust plastic construction
- » Up to four inputs
- » 'Touch' buttons
- » Compatible with any of our wired cameras
- » 7 inch LCD screen

M3038



CWM-700 Series, Waterproof

A 7 inch metal waterproof monitor ideal for use on construction sites and other similar locations.

- » Up to four inputs
- » Waterproof
- » Compatible with any of our wired cameras
- » 7 inch LCD screen

GP3292



GP Monitor

A cost-effective, functional plastic monitor.

- » Three inputs
- » Compatible with any of our wired cameras
- » 7 inch LCD screen

GP3316



GP Metal Monitor, Waterproof

A lower-cost alternative to the CWM-700 series of monitors. Able to withstand the conditions generally found on construction sites and other similar environments.

- » Three inputs
- » Waterproof
- » Compatible with any of our wired cameras
- » 7 inch LCD screen

M3199



CM-510

A 5 inch plastic monitor, normally utilised with our Multi-Vue™ wired camera system.

- » Two inputs
- » Compatible with any of our wired cameras
- » 5 inch LCD screen

M3345



CWM-510, Waterproof

A 5 inch metal waterproof monitor, ideal for use on construction sites and other similar environments when there is not enough room for a 7 inch monitor.

- » Two inputs
- » Waterproof
- » Compatible with any of our wired cameras
- » 5 inch LCD screen

M3385



CM-720A

A recent addition to Trailer Vision's range, this monitor is generally utilised with our Cycle-Safe™ system.

- » Two inputs
- » Robust plastic construction
- » 7 inch screen

GP3226



Mirror-Mounted Monitor

Perfect for use in a motorhome or van, this mirror-mounted monitor sits where you naturally glance at in order to see what is behind you.

- » One input
- » Robust plastic construction
- » Compatible with any of our wired systems
- » 7 inch LCD screen

M3251



CWM-1000, Waterproof

The CWM-1000 offers the very best views at a cost-effective price.

- » One input
- » Waterproof
- » 10 inch LCD Screen

M3252



CWM-1004, Waterproof

Our flagship 10 inch metal waterproof monitor, the CWM-1004 offers the very best views at a cost-effective price.

- » Four inputs
- » Waterproof
- » 10 inch LCD Screen

Analogue Wired System Extras and Accessories

P1058



Digital Wireless Modules

Enables any of our Digital HD and analogue wired systems to be operated wirelessly.

- » Ideal for operating multiple trailers
- » No physical tractor/trailer connection
- » Automatic pairing
- » Water-resistant, IP69K
- » Interference-free with a range of up to 100m
- » 3 year warranty

P1091



GP TX & RX

A lower-cost, non-waterproof alternative to Digital Wireless Modules (P1058). Compatible with Digital HD and analogue wired systems.

- » Ideal for operating multiple trailers
- » No physical tractor/trailer connection
- » Interference-free with a range of up to 100m
- » 2 year warranty

AL3255



Turning Warning Alarm

Essential for achieving compliance for your fleet.

AL3253



Reversing Alarm

Essential for achieving compliance for your fleet.

P3078/80/81



Camera Extension Cable, 6 Pin

Available in the following lengths:

- » P3078 - 5m Length
- » P3080 - 10m Length
- » P3081 - 18m Length

GP3223/24/25



GP Camera Extension Cable, 4 Pin

Available in the following lengths:

- » GP3223 - 5m Length
- » GP3224 - 10m Length
- » GP3225 - 15m Length

P3086/87



Splitter Cable, 6 Pin

Available in the following lengths:

- » P3086 - 45cm Length
- » P3087 - 45cm & 85cm Length

GP3420



Splitter Cable, 4 Pin

Available in the following lengths:

- » GP3420 - 25cm Length

P3094



Suzy Kits, 6 Pin

Allows any of our 6 pin wired camera kits to be used on articulated vehicles.

- » P3094 - 1 Camera Kit
- » P3095 - 2 Camera Kit
- » P3096 - 3 Camera Kit
- » P3097 - 4 Camera Kit

GP3222



Suzy Kit, 4 Pin

Allows any of our 4 pin wired camera kits to be used on articulated vehicles.

P3087/91



Pin-to-Pin Adapters

Available in the following configurations:

- » P3087 - 4 Pin to 6 Pin (Male)
- » P3091 - 4 Pin to 6 Pin (Female)

P30XX



Camera Brackets

Available for all cameras. Please contact us for assistance.

P31XX



Monitor Mounts

Allows monitors to be mounted to a dashboard, windscreen or roof.

Mounts are available for all of our monitors. Please get in touch for assistance.

P1054



"Blind Spot, Take Care" Vinyl

Essential for achieving compliance.

P30XX



Monitor Power Looms

Available for all monitors. Please contact us for assistance.

P3315

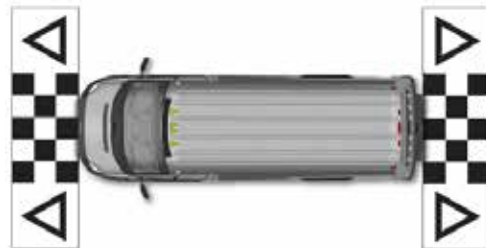

Calibration Kit

Needed when installing a surround view system without the aid of our engineers. The cost of the calibration kit is fully refundable upon its return to us.

Digital Wireless Systems

Interference-free



Why Buy From Us

Trailer Vision were the first company in the UK to introduce wireless and interference-free digital wireless (DW) systems, ensuring that our knowledge of wireless technology is unsurpassed.

We continue to lead the market with the introduction of the first completely automatic pairing DW modules (Transmitter & Receiver) - see Wired Accessories and Extras, Page 30).

A1084

New!



Digi-Max3™

12V/24V

Digi-Max3™ is a brand new, significantly improved (AHD) version of the original and very popular Digi-Max™ system.

Interference-free and featuring the latest digital wireless (DW) technology, Digi-Max3™ is essential for many applications where it is impractical to run a cable between the camera and monitor (200m range).

The system also features semi-automatic pairing via the monitor, split screen views and the camera includes a built-in microphone (monitor with built-in speaker that can be muted).

- » A1084 - Full System with 1 Camera
- » A1085 - Full System with 2 Cameras
- » A1086 - Full System with 3 Cameras
- » A1087 - Full System with 4 Cameras

A1002



Digi-View™

12V/24V

Digi-View™ is the original digital wireless (DW) camera system, which featured the very latest technology and set the standard.

Digi-View™ incorporates digital technology, ensuring that it can be used at the same time as Bluetooth devices, or wireless networks, interference free (200m range).

The colour LCD monitor can be used with up to 4 cameras, including a reversing camera.

- » A1001 - Full System with 1 Camera
- » A1002 - Full System with 2 Cameras
- » A1049 - Full System with 3 Cameras
- » A1050 - Full System with 4 Cameras

A1048



Agri-View™

12V/24V

Save time while avoiding accidents and incidents with Agri-View™, featuring a useful split-screen view.

Interference-free and featuring the latest digital wireless (DW) technology, Agri-View™ is essential for many applications where it is impractical to run a cable between the camera and monitor (200m range).

The included monitor has a built-in speaker, which utilises the camera's microphone.

- » A1047 - Full System with 1 Camera
- » A1048 - Full System with 2 Cameras

A1028



Equi-Vue2™

Specifically developed for the Equestrian market, the Equi-Vue2™ generates its own Wi-Fi signal to transmit video straight to your smart devices.

The easiest to fit system on the market.

GP1076



GP DW Monitor and TX

This system, which comes with a monitor and transmitter, enables any of our wired cameras and surround view systems to be utilised wirelessly.

Applications include caravan and trailer use.

Y3307



Yard-Vue™

Yard-Vue™ is an innovative, high-definition IP camera which can be viewed and heard from anywhere in the world at any time.

Users simply connect smart devices (tablet, phone etc.) via the free of charge app to view images in real-time.

Y3307



Digi-Hitch™

An additional number plate camera and transmitter to utilise with Digi-View™, Digi-Lite™ and Digi-Lite™ Deluxe.

A1032



Digi-Lite™ 12V

Integrated into the numberplate holder and designed for utilisation with cars, vans, caravans and motorhomes, the Digi-Lite™ is a discreet digital wireless system with multiple applications.

Digi-Lite™ comes with a 3.5 inch monitor as standard.

A1008



Digi-Lite™ Deluxe 12V

An upgraded version of Digi-Lite™ (A1032), Digi-Lite™ Deluxe replaces the 3.5 inch monitor with a 7 inch mirror-mounted monitor.

As with all our systems, the Digi-Lite™ Deluxe is interference-free.

A1070

New!



Digi-Lite™ Solar

BRAND NEW!

Digi-Lite™ Solar is a brand-new digital wireless (DW), solar powered, reversing camera system.

The system is specifically designed for light vehicles and trailers, including cars, vans, motor-homes and caravans.

It utilises a small camera, which is integrated into the number-plate holder. The camera lens direction/angle can also be adjusted up/down.

The number plate holder also includes a rechargeable/solar powered battery, meaning that it is easily installed within minutes. Best of all, there is no wiring!

The monitor can either be mounted on to a dashboard, air-vent, or windscreen and is powered via a cigarette lighter power adaptor.



Digital Wireless Cameras

Compatible with our wireless systems. Please read the descriptions before ordering.

C1003



Digi-Cam™ (12V/24V)

Compatible with the Digi-View™ and Digi-Lite™ systems.

Requires a power source (i.e., side lights, rear lights) and basic DIY skills to install.

- » Durable metal case
- » Digital wireless connection to monitor
- » Night vision
- » IP66 water resistant
- » Aerial included

C1009



Digi-Cam2™ (12V/24V)

Compatible with the Digi-Max2™ system ONLY.

Requires a power source (i.e., side lights, rear lights) and basic DIY skills to install.

- » Durable metal case
- » Digital wireless connection to monitor
- » Night vision
- » IP67 water resistant
- » Aerial included

C1082



Digi-Cam3™ (12V/24V)

Compatible with the Digi-Max3™ system ONLY.

Requires a power source (i.e., side lights, rear lights) and basic DIY skills to install.

- » Durable metal case
- » AHD
- » Digital wireless connection to monitor
- » Simple pairing
- » Night vision
- » IP69 water resistant
- » Aerial included

C3418



Agri-Cam™ (12V/24V)

Compatible with the Agri-Vue™ system ONLY.

Requires a power source (i.e., side lights, rear lights) and basic DIY skills to install.

- » Durable metal case
- » Digital wireless connection to monitor
- » Simple pairing
- » Night vision
- » IP69 water resistant
- » Aerial included

Wireless Monitors

Compatible with our wireless systems. Please read the descriptions before ordering.

M1006



Digi-View™ Monitor

Compatible with Digi-Cam™ (C1003) cameras ONLY.

- » Free from interference
- » 3.5 inch display
- » Supports up to four camera connections at one time
- » Completely digital
- » Durable and reliable
- » 2 year warranty

M1012



Digi-Max2™ Monitor

Compatible with Digi-Cam2™ (C1009) cameras ONLY.

- » Free from interference
- » 7 inch display
- » Supports up to four camera connections at one time
- » Completely digital
- » Durable and reliable
- » 2 year warranty

M1080



Digi-Max3™ Monitor

Compatible with Digi-Max3™ (C1082) cameras ONLY.

- » Free from interference
- » Simple pairing via monitor
- » Able to pair with four cameras at a time
- » 7 inch AHD display
- » Completely digital display
- » Durable and reliable
- » Split-screen functionality
- » Speaker
- » 2 year warranty

M3417



Agri-Vue™ Monitor

Compatible with Agri-Vue™ (C3418) cameras ONLY.

- » Free from interference
- » Simple pairing via monitor
- » Able to pair with two cameras at a time
- » 7 inch display
- » Durable and reliable
- » Completely digital display
- » Split-screen functionality
- » Speaker
- » 2 year warranty

Digital Wireless System Extras and Accessories

B3317



Industrial Battery Packs, 12V

Move your cameras between vehicles easily with the features:

- » Provides power for 10+ hours
- » Waterproof (metal)
- » Integral mag mount
- » On/Off button & LED power indicator
- » Discounted when bought with a system
- » Mains & 12V charger
- » 3 year warranty

P1016



Mag Mount

Compatible with the following cameras:

- » Digi-Cam™
- » Digi-Cam2™
- » Digi-Cam3™
- » Agri-Cam™

P1056



Monitor Square Attachment

Compatible with the following monitors:

- » Digi-View™ monitor
- » Digi-Max2™ monitor

P1014



3dB Aerial

Available with male or female connections. Please specify which connection is required when ordering.

Compatible with the following systems and cameras:

- » Digi-Max™
- » Digi-Max2™
- » Digi-View™
- » Digi-Cam™
- » Digi-Cam2™
- » Digi-Cam3™
- » Yard-View™

P1020



5dB Aerial

Available with male or female connections. Please specify which connection is required when ordering.

Compatible with the following systems and cameras:

- » Digi-Max™
- » Digi-Max2™
- » Digi-View™
- » Digi-Cam™
- » Digi-Cam2™
- » Digi-Cam3™
- » Yard-View™

P1004



Digi-View™ Monitor Hard Wire Adapter

Enables the Digi-View™ monitor to be hard-wired in to your vehicle's power supply.

P1010



Digi-Max2™ Monitor Hard Wire Adapter

Enables the Digi-Max2™ monitor to be hard-wired in to your vehicle's power supply.

P1044



USB Charging Lead

Compatible with the following:

- » Equi-View2™ Camera
- » Digi-View™ Monitor

P3406



Digi-View™ Monitor Mains Adapter

Allows the Digi-View™ monitor to be powered via mains.

P1044



Digi-Max2™ Monitor Mains Adapter

Allows the Digi-Max2™ monitor to be powered via mains.

P3408



Digital Wireless Camera Mains Adapter

Allows any of our digital wireless cameras to be powered via mains.

P1005



Digi-View™ Monitor 12V/24V Adapter

Provides power to the Digi-View™ monitor when utilised inside a vehicle.

P1039



Digi-Max™ Monitor 12V/24V Adapter

Provides power to the Digi-Max™ monitor when utilised inside a vehicle.

P1011



Digi-Max2™ Monitor 12V/24V Adapter

Provides power to the Digi-Max2™ monitor when utilised inside a vehicle.

P1081



Digi-Max3™ Monitor 12V/24V Adapter

Provides power to the Digi-Max3™ monitor when utilised inside a vehicle.

P1021



Monitor Windscreen Mount

Compatible with the following monitors:

- » Digi-View™ Monitor
- » Digi-Max™ Monitor
- » Digi-Max2™ Monitor

P1083



Digi-Max3™ Monitor Windscreen Mount

Compatible with the Digi-Max3™ monitor.

P1057



Monitor Dashboard Mount

Allows the following monitors to be attached to a dashboard:

- » Digi-View™ Monitor
- » Digi-Max2™ Monitor

GP1061



Digi-Max3™ Monitor Dashboard Mount

Compatible with the Digi-Max3™ monitor.

Installation



Trailer Vision is proud to offer a national fitting service at your location(s), whether for a single vehicle or a large fleet.

What is the process?

Once you have selected your system(s) and are ready to order, contact us and we will confirm the installation cost.

We will need to know the vehicle/machine make and/or model, registration and availability. Out of hours and weekend installations are available in addition to slots that fall within the working week. We will also need to know the site contact details for multiple installations.

After a fitting date is agreed, a pro-forma invoice is raised and sent via email. The invoice includes all costs and acts as our official quote. There is no obligation on the part of the customer at this stage. Systems can also be quoted for separately to installation.

Credit terms (subject to checks) are also available and large fleet installations can be invoiced monthly.



Installation Examples

We are proud of our products and are happy to show the results



TRAILER VISION LTD
THE PADDOCKS
FOLKSWORTH ROAD
NORMAN CROSS
PETERBOROUGH
PE7 3SP

PHONE: 01733 246473

EMAIL: SALES@TRAILERVISION.CO.UK
WEBSITE: WWW.TRAILERVISION.CO.UK

